

GENERAL CONSTRUCTION NOTES:

1. CONSTRUCTION AND STRUCTURES SHALL COMPLY WITH ALL MUNICIPAL OR STATE REQUIREMENTS. ALL WORK SHALL BE CERTIFIED BY A REGISTERED PROFESSIONAL ENGINEER, TO THE SATISFACTION OF THE ENGINEERING BUREAU, THAT CONSTRUCTION IS IN ACCORDANCE WITH THESE PLANS.
2. THE ENGINEERING BUREAU OF THE DEPARTMENT OF PUBLIC WORKS AND THE ENGINEER OF RECORD SHALL BE NOTIFIED THREE DAYS PRIOR TO THE COMMENCEMENT OF EACH PHASE OF CONSTRUCTION.
3. NO CERTIFICATE OF CONFORMANCE TO STANDARDS SHALL BE ISSUED BY THE DESIGN ENGINEER IF PROPER NOTICE IS NOT PROVIDED FOR INSPECTIONS OR IF INSPECTIONS ARE NOT MADE PRIOR TO BACKFILLING OF BELOW GROUND STRUCTURES AND APPURTENANCES.
4. SUBSURFACE STRUCTURES AND UTILITIES HAVE BEEN DETERMINED FROM EXISTING RECORDS AND ARE NOT GUARANTEED TO BE COMPLETE OR ACCURATE. IN ORDER TO AVOID CONFLICT OF THE PROPOSED WORK AND EXISTING UTILITIES, THE CONTRACTOR SHALL LOCATE EXISTING UTILITIES BY EXCAVATING TEST HOLES. IF THE CONTRACTOR DETERMINES THAT A CONFLICT EXISTS, HE SHALL IMMEDIATELY NOTIFY THE ENGINEER, WHO WILL MAKE THE NECESSARY ADJUSTMENTS.
5. EXISTING PROPERTY AND UTILITY INFORMATION WAS TAKEN FROM A SURVEY BY DENNIS A. DEILUS LAND SURVEYORS TITLED "ZONING MAP OF PROPERTY PREPARED FOR SHIVAM & J. KRUPA INC.", DATED SEPTEMBER 4, 2019.
6. ALL SANITARY SEWER PIPE SHALL BE EITHER SDR-35 P.V.C. (ASTM D-3034) OR CLASS 52 DUCTILE IRON (ANSI A 21-51), AS INDICATED ON THE PLANS, UNLESS OTHERWISE INDICATED. ALL SANITARY SEWER PIPE SHALL HAVE RUBBER GASKET SLIP-TYPE JOINTS. INFILTRATION INTO SANITARY SEWERS SHALL NOT EXCEED 150 GALLONS PER INCH OF PIPE DIAMETER PER MILE OF PIPE IN 24 HOURS.
7. NO PIPE SHALL HAVE A BEND OF GREATER THAN 45 DEGREES.
8. THE CONTRACTOR SHALL NOTIFY "CALL BEFORE YOU DIG" AT 1-800-922-4455, OR OTHER APPROPRIATE CONTACT POINT PRIOR TO START OF CONSTRUCTION.
9. ALL UTILITY LOCATIONS ARE APPROXIMATE. IT IS THE RESPONSIBILITY OF THE CONTRACTOR TO CONFIRM THE LOCATION OF THE UTILITIES IN THE FIELD BY WHATEVER MEANS HE DEEMS PRUDENT.
10. THIS DESIGN CONFORMS TO APPLICABLE CODES AND ACCEPTED PRACTICE, NO OTHER WARRANTY IS EXPRESSED OR IMPLIED.
11. TOTAL SITE AREA = 0.394 ACRES

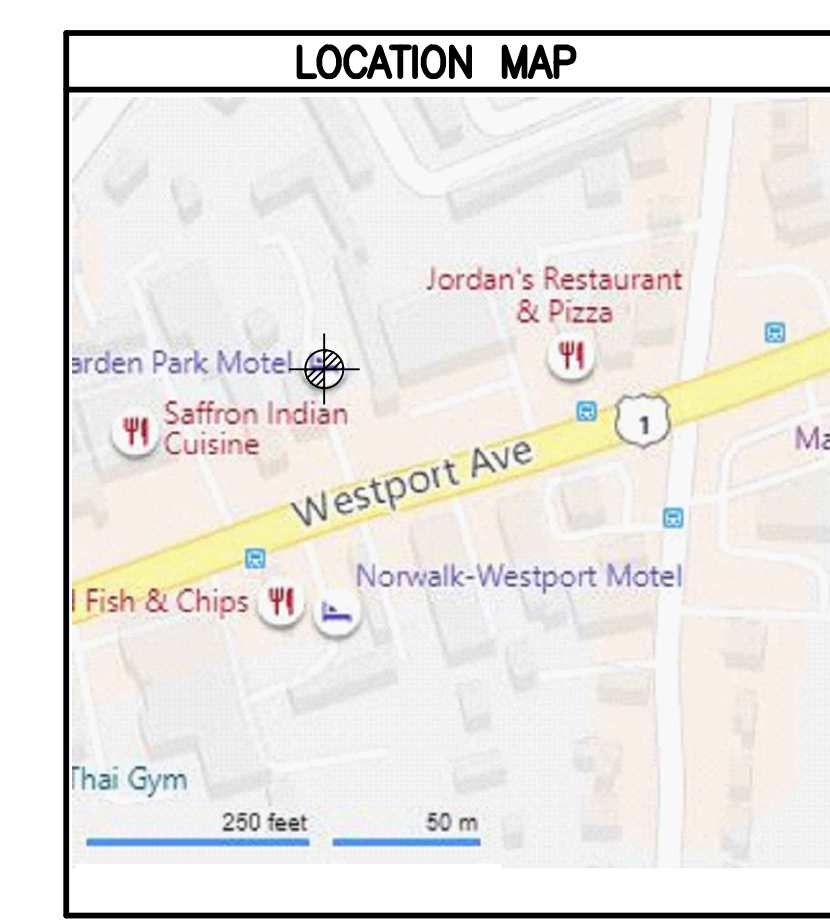

- SEDIMENTATION AND EROSION CONTROL NOTES**
1. LAND DISTURBANCE SHALL BE KEPT TO A MINIMUM. PERMANENT STABILIZATION SHALL BE SCHEDULED AS SOON AS FINAL GRADES ARE ESTABLISHED.
 2. ALL DISTURBED AREAS SHALL BE FINE GRADED AND SEEDED WITH AN APPROVED SEED MIXTURE. COVER NEWLY SEEDED AREAS WITH MULCH HAY OR SALT HAY.
 3. ALL EROSION AND SEDIMENT CONTROL MEASURES SHALL BE CONSTRUCTED IN ACCORDANCE WITH THE STANDARDS AND SPECIFICATIONS OF THE 2002 CONNECTICUT "GUIDELINES FOR SOIL EROSION AND SEDIMENT CONTROL" HANDBOOK.
 4. ALL CONTROL MEASURES SHALL BE MAINTAINED IN EFFECTIVE CONDITION THROUGHOUT THE CONSTRUCTION PERIOD. CHECK AFTER EACH STORM EVENT.
 5. ADDITIONAL CONTROL MEASURES SHALL BE INSTALLED DURING THE CONSTRUCTION PERIOD, IF REQUIRED BY TOWN AUTHORITIES.
 6. SEDIMENT DEPOSITS REMOVED FROM FILTER BARRIERS SHALL BE PLACED IN FILL AREAS OR SPREAD WHERE THERE IS PROPOSED VEGETATIVE COVER. ANY SEDIMENT DEPOSITS REMAINING AFTER THE FILTER BARRIER IS REMOVED SHALL BE FINE GRADED AND PLANTED ACCORDING TO PLAN.
 7. THE SITE CONSTRUCTION CONTRACTOR IS ASSIGNED THE RESPONSIBILITY FOR IMPLEMENTING THIS EROSION AND SEDIMENT CONTROL PLAN. THIS RESPONSIBILITY INCLUDES THE INSTALLATION AND MAINTENANCE OF CONTROL MEASURES, INFORMING ALL PARTIES ENGAGED ON THE CONSTRUCTION SITE OF THE REQUIREMENTS AND OBJECTIVES OF THE PLAN, NOTIFYING THE PLANNING AND ZONING OFFICE (AND/OR THE CONSERVATION COMMISSION) OF ANY TRANSFER OF THIS RESPONSIBILITY AND CONVEYING A COPY OF THE EROSION AND SEDIMENT CONTROL PLAN IF THE TITLE TO THE LAND IS TRANSFERRED TO A NEW OWNER.

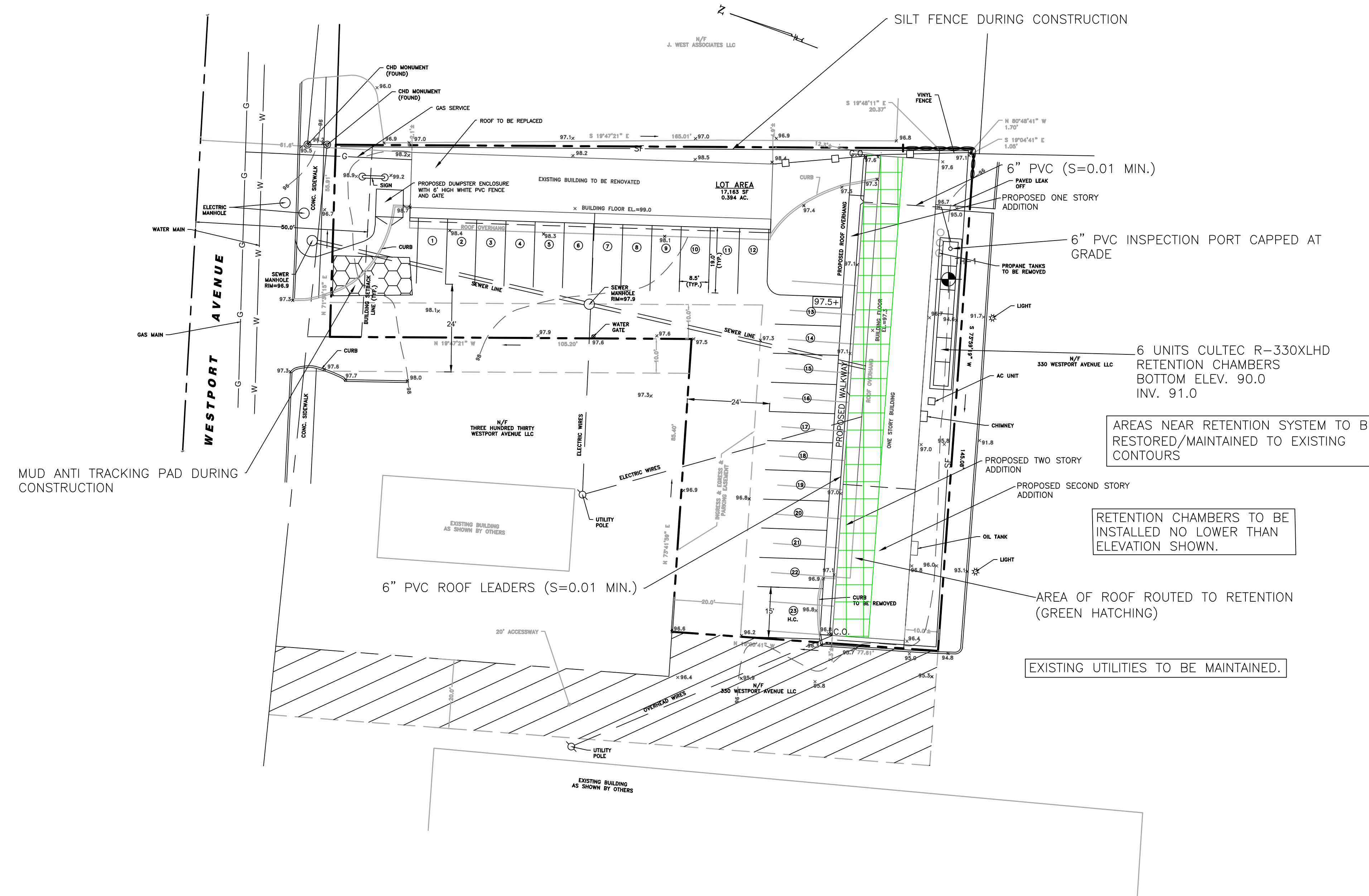
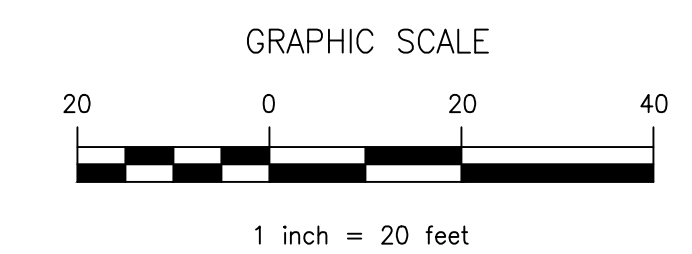

	SHIVAM & J. KRUPA INC. 344 WESTPORT AVENUE NORWALK, CONNECTICUT	
	5-25-21 date	
DRAINAGE PLAN		
CIVIL ENGINEERS		1763 project
FAIRFIELD COUNTY ENGINEERING L.L.C. 80 WINFIELD STREET, NORWALK, CONNECTICUT 06855 PH: (203) 831-8005 FAX: (203) 831-8006		
		1 OF 2 sheet